

TECHNICAL DRAWING

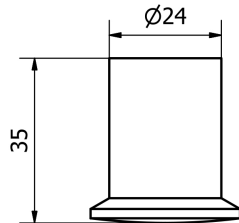

PHOTO

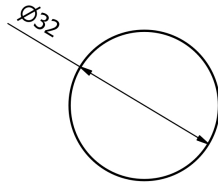

PRODUCT FAMILY: ACCESSORIES - ELEGANCE SERIES
CODE: ELAPPBC
DESCRIPTION: Coat hook made of turned aluminium. Color mat white

MECHANICAL PERFORMANCES:

APPROVALS/CERTIFICATIONS:
 TUV system certification UNI EN ISO 9001

PRODUCT FEATURES:

Coat hook made of turned aluminium, with bushing in brass. Powder coated, mat white.

FIXING/INSTALLATION:

Wall fixation with n°1 rawplug

Rawplugs not included in the package.

Choose a proper rawplug considering the type of wall on which you are going to install the product.

Hole for screw Ø max 8,5

MAINTENANCE:

Check periodically the correct fixation of the accessories.
 Make a proper cleaning with water and soap, do not use abrasive or corrosive products.

PRODUCT COMPOSITION:

MATERIALS:

TREATEMENTS:

N° 1 Coat hook. Aluminium, painted RAL9016
 N° 1 Bushing in brass

TOLERANCES:

0÷300±3 301÷600±4 601÷2000±5

PACKAGING OF THE PRODUCT:

Single packaging with pluriball and carton box 80 x 80 x 40 mm
 Weight: 0,04 kg

ST_PRODOTTO: ELAPPBC	- 1	APPROVATO
REV.00 DEL 26/11/19		R.T.

